



swisherinc.com

INSTRUCTION MANUAL

4607



IMPORTANT

Read and follow all Safety
Precautions and Instructions
before operating this
equipment.

Rev. 01.06.04

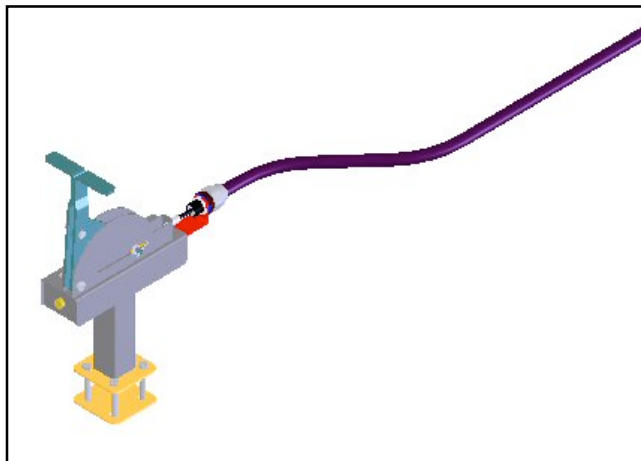

44'' TRAILMOWER® REMOTE BLADE ENGAGE KIT

**Assembly
Operation
Service and Adjustment
Repair Parts**



1602 CORPORATE DRIVE, P.O. BOX 67, WARRENSBURG, MISSOURI 64093
PHONE 660-747-8183 FAX 660-747-8650

Manufacturing quality lawn care equipment since 1945

Made In The

USA



Tools required

3/8"-7/16"-1/2"-15/16" open end wrenches

Nyloc nuts are difficult to remove and may require two wrenches

REMOVING MANUAL ENGAGEMENT ASSEMBLY

See figure - 1

- Shut off mower and allow time to cool.
- Loosen and remove four 1/2" screws [NB161] and remove both belt covers [4524] .
- Loosen and remove nuts [NB181 & NB170] , bolt [NB501] , washers [NB556] , spring [6048] , and tension rod [NB260] .
- Loosen and remove two 1/2" bolts [NB250] in engagement standoff [4547TK] .
- Remove nut [NB210] on tension rod at pivot plate [4578TK] and remove entire assembly. [detail-1]

FIGURE - 1

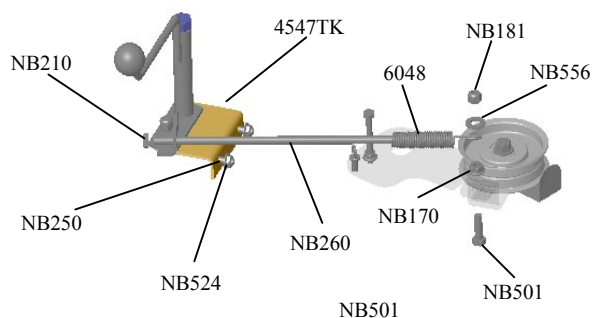

INSTALLATION OF REMOTE ENGAGEMENT KIT

See FIGURE - 2

- Insert one 5/16" bolt [NB501] into hole closest to the end of [4504TK] spring bracket and one 5/16" nut [NB170] onto bolt upside down [DO NOT TIGHTEN] . Plate should pivot freely.
- Place spring bracket [4504TK] onto the arm of idler bracket [4530TK] and tighten with one nut [NB170] .
- On other end of spring bracket [4504TK] place one 5/16" bolt [NB501] into hole up from the bottom and tighten one 5/16" nut [NB170] tight.
- Place two washers [NB272] onto bolt and one 5/16" nylock nut [NB181] allow for the spring on the engagement cable to fit between the two washers

FIGURE- 2

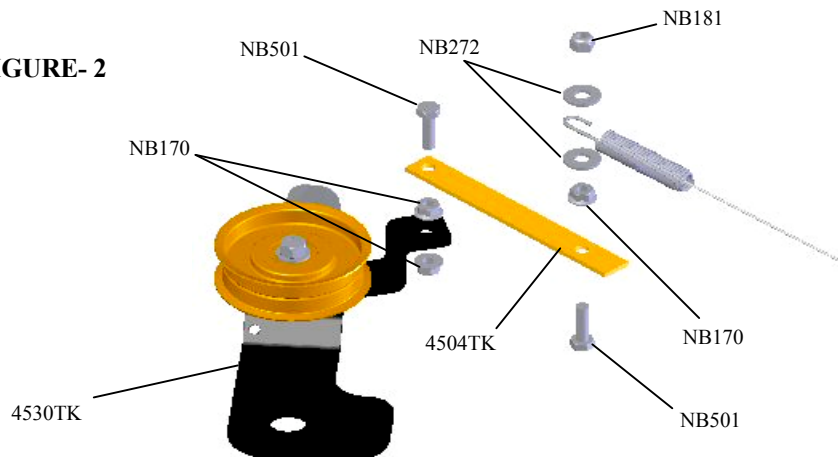

Mounting remote cable bracket [4599TK]

- After removing the standard engagement assembly attach the remote cable bracket in the same location using two 1/2"-20 bolts [NB250] and two 1/2"-20 nuts [NB524]. Tighten bracket to mower.
- Place wires and cable from harness into bracket as shown in **FIGURE-4** [leave adjustment nuts loose at this point.]
- Route smaller tube of wires under hitch bracket over to key switch .
- Unplug wires and remove key switch **FIGURE-3**
- Insert tube and wires from new harness into key switch hole and reconnect, remember green wire to green wire and red wire to red wire.
- Route spring cable through slot and attach to spring mount arm [4604TK]. Spring should move freely.
- Adjust cable nuts at this point. The goal is to minimize slack **DO NOT ADJUST CABLE TIGHT** -- this can cause damage to the cable.

FIGURE - 3

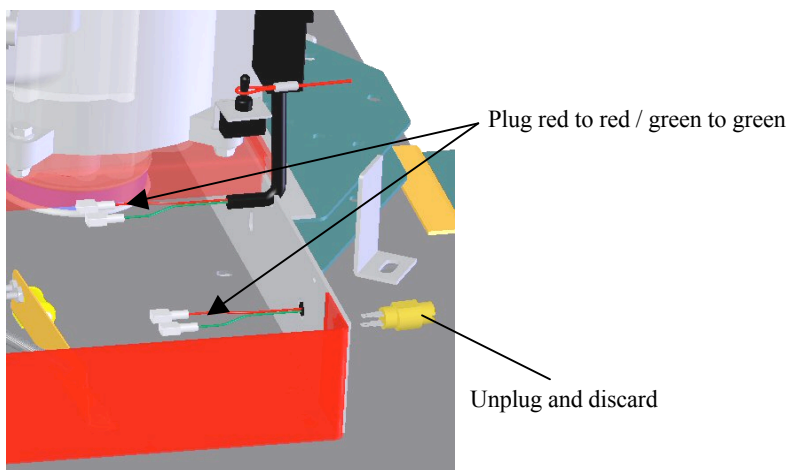
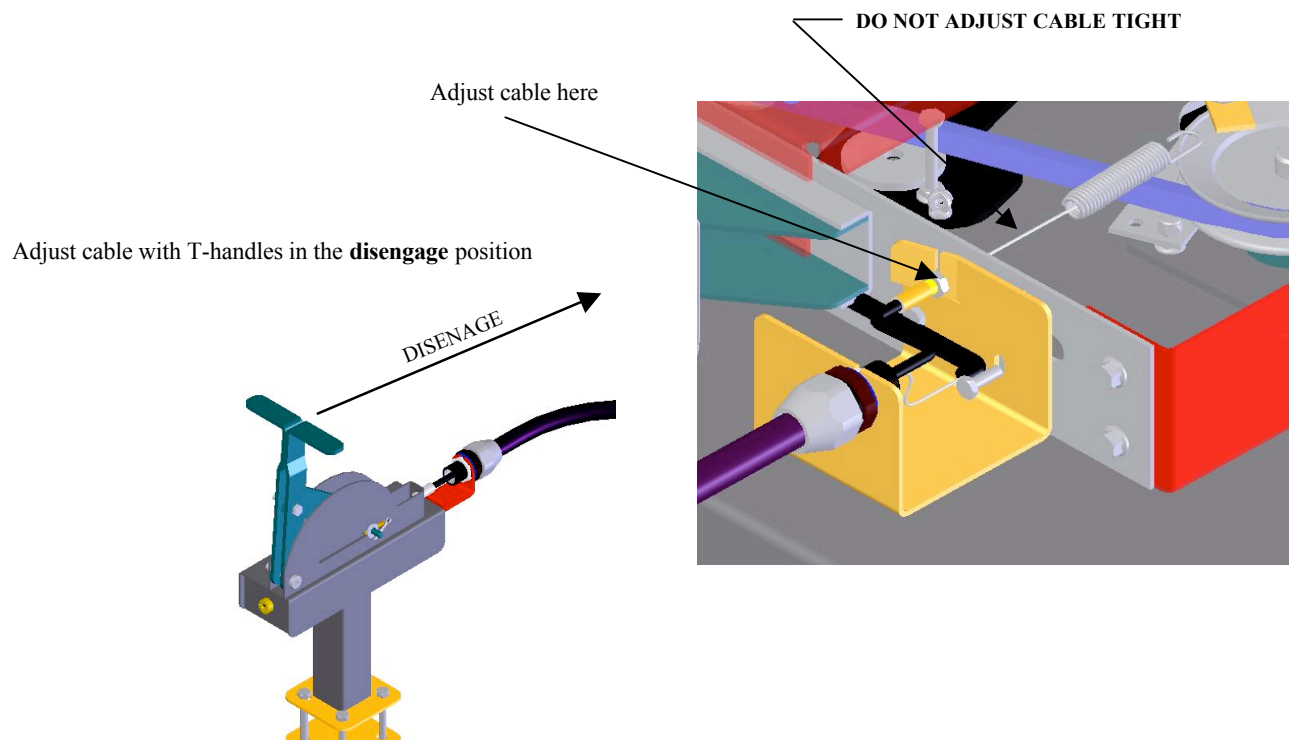
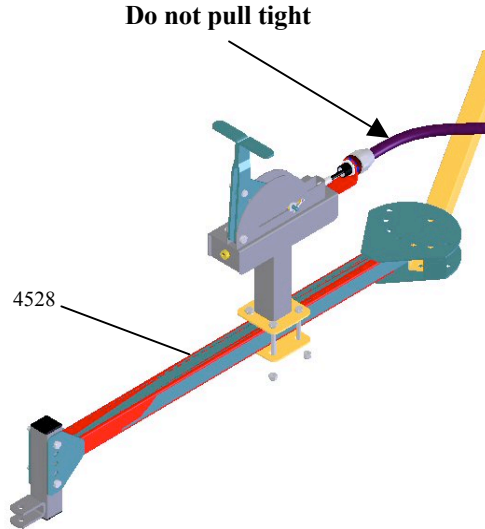

FIGURE - 4



Mounting remote console

Attach console to fan hitch [4582] using nuts and bolts provided in this kit. **NOTE:** Wiring harness should **not** be pulled tight -- this can cause damage when making sharp turns.



TESTING AND CONDITIONING REMOTE BLADE ENGAGE ASSEMBLY



IMPORTANT

NEVER START OR OPERATE MOWER UNTIL COVERS, GUARDS, AND ALL OTHER SAFETY PIECES ARE PROPERLY IN PLACE!

- Ensure area is free of debris that may be thrown by blades.
- Be aware of anyone that may be in the discharge path, especially small children.
- Start engine and allow a few seconds to warm up.
- Using the remote handles cycle blade engage between full speed and full stop. Repeat several times to ensure proper installation.
- It may be necessary to adjust cable to improve function [figure-4 page -3] **NOTE:** Remember to allow time for mower to cool between adjustments and return covers and guards before re-starting.

