

FRANCHI 12 GAUGE SEMI-AUTOMATIC SHOTGUN

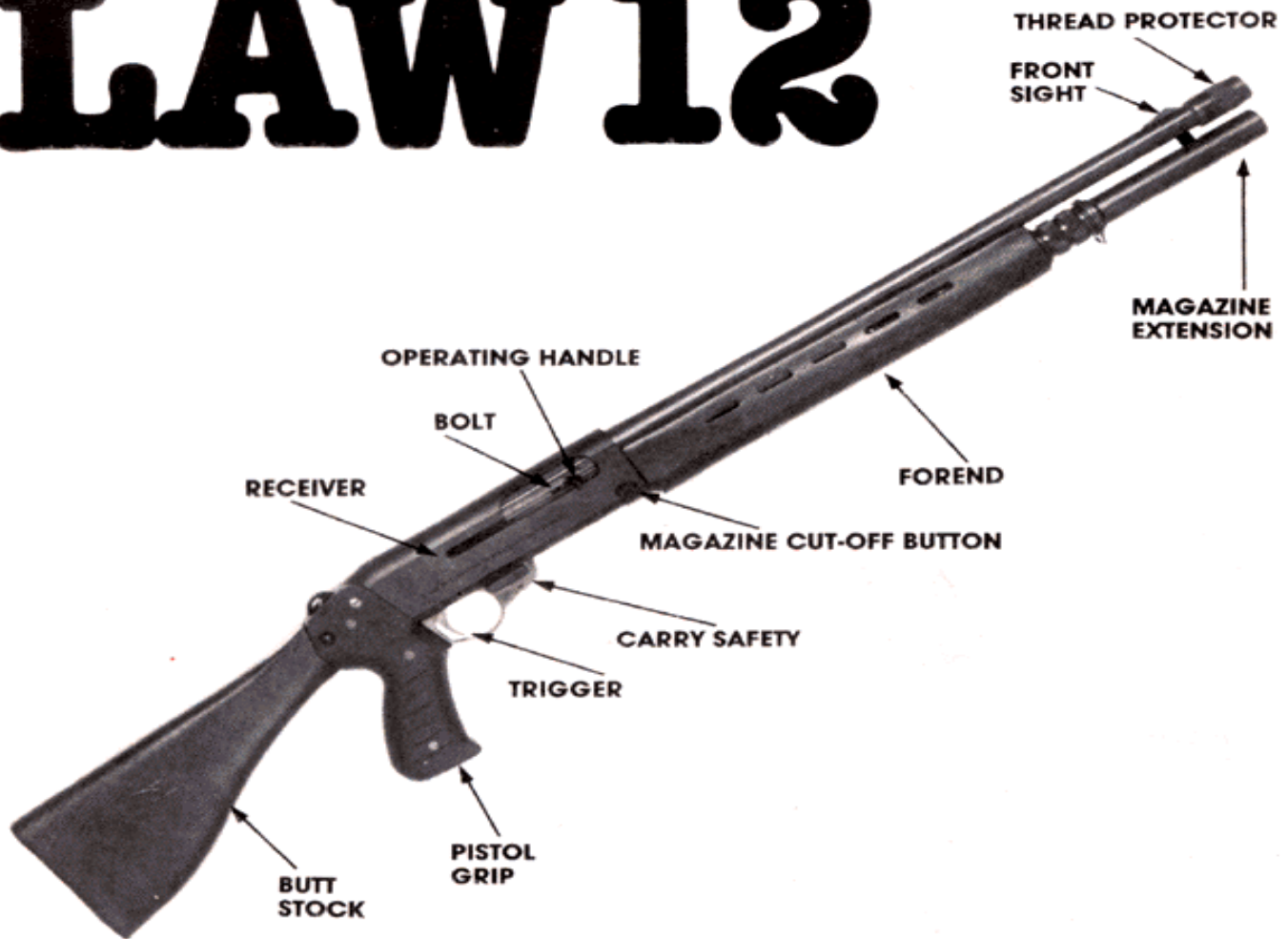

LAW 12



HONESTLY NOW...

have you read this Owner's Manual?

1

HOW TO USE THE SAFETIES

There are 2 safeties on your **LAW 12**.

1. Carry safety (for general use)
2. Quick employment safety (for competition use, and for tactical situations)

Use one or both of them at all times. Do not take off both safeties until the moment of firing, to help protect against accidental firing and possible injury or death of yourself or others.

THE CARRY SAFETY

This large lever on the right side of the trigger guard points **FORWARD TO FIRE** and **BACK FOR "ON SAFE"**. It is your main safety, blocking the hammer. Use it until ready to fire or until switching over to the quick employment safety.

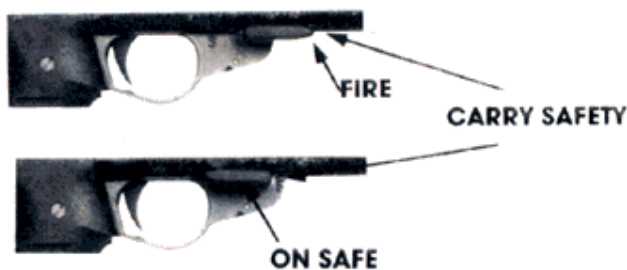

The carry safety should only be engaged when the **LAW 12** is cocked. With bolt closed and hammer **UNCOCKED**, engaging the carry safety prevents opening the bolt and cocking the gun.

THE QUICK EMPLOYMENT SAFETY

This flat blade on the left side of the trigger guard is also **FORWARD TO FIRE** and **BACK FOR "ON SAFE"**.



It disconnects the trigger. It can be moved "off safe" very quickly with the trigger finger. It provides safety even when instant readiness is needed. You can have it "on safe" while the carry safety is "on safe" so it will already be "on" when you disengage the carry safety.

IT UNLOCKS

THE BOLT When the action is cocked and the bolt is closed the bolt is **LOCKED SHUT** for maximum safety. Firing (or dry firing) unlocks the bolt so the action may cycle. To unlock the bolt without firing, move the quick employment safety back to "ON SAFE" and the bolt may be opened.

2 HOW TO LOAD AND UNLOAD

IMPORTANT EASY-LOADING TIP

The shell carrier (Part No. 93) has 2 spring tensions. With the hammer cocked, it is easy to move, but with the hammer uncocked it is more difficult. **YOU WILL FIND LOADING MUCH EASIER WITH THE GUN COCKED, but be very careful to be sure the chamber is empty for safety.**

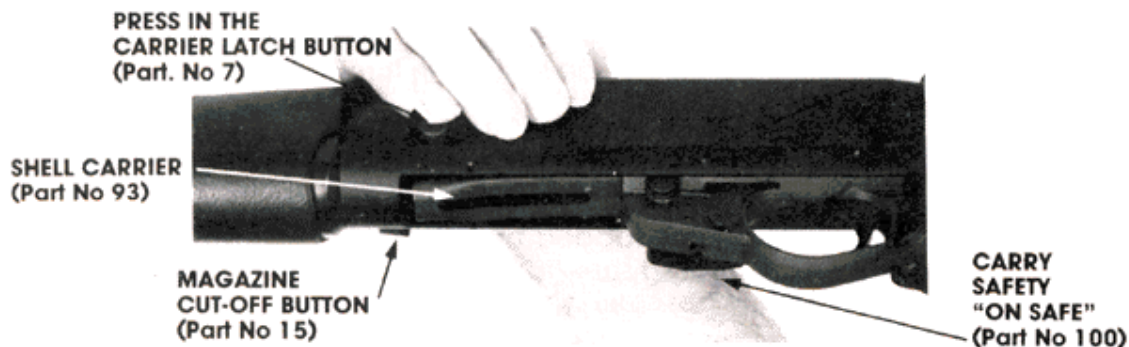

With the carry safety "on safe" hold the **LAW 12** upside down, press the carrier latch button and push 8 12 ga. $2\frac{3}{4}$ " shells into the magazine to load it fully.

TO UNLOAD

There are two methods for unloading the **LAW 12**.

You may cut off the ammunition supply from the magazine by pressing the magazine cut-off button in until it catches. Move the quick employment safety back to the "on safe" position and open the bolt, ejecting the shell from the chamber. Close the bolt by pressing the carrier latch button on the left side of the receiver. Holding the shotgun bottom up, release the magazine cut-off button and press the carrier latch button. Reach in and press the magazine shell latch (Part No. 13) with the tip of your finger, and let the shells slip out one by one.

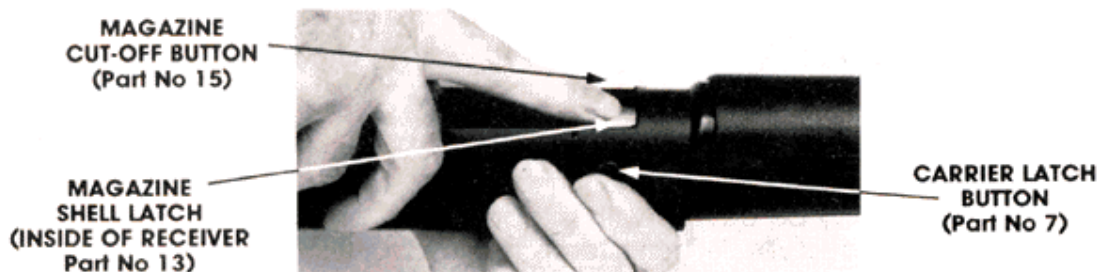

Or simply eject the shells manually, by pulling back on the operating handle to cycle them through the chamber. **Use caution when doing this. To unlock the bolt after it closes each time, engage the quick employment safety. Keep the carry safety "on safe" all during this procedure.**

3 HOW TO PREPARE FOR FIRING

Activate one or both safeties.

NOTE: The carrier latch button is on the left side of the receiver. It releases the bolt when the bolt is locked open.

The chamber of the **LAW 12** can be loaded in three different ways:

- The chamber may be loaded before loading the magazine by opening the bolt, placing a shell in the receiver and closing the bolt by pushing the carrier latch button on the left side of the receiver.
- The chamber may also be loaded by loading the magazine, then operating the bolt to feed a shell from the magazine into the chamber, then loading another shell into the magazine.
- Or the chamber may be loaded by loading the magazine, pushing the magazine cut-off button, opening the bolt, placing a shell in the receiver, and closing the bolt by pushing the carrier latch button on the left side of the receiver. **CAUTION: IF YOU RELEASE THE MAGAZINE CUT-OFF BUTTON BEFORE CLOSING THE BOLT, THE GUN WILL JAM.**

If you leave the magazine cut-off button engaged, the firing of a shot will release it automatically, or you may do it manually AFTER the bolt is closed.

With magazine and chamber loaded you are ready to select a safe target, move the safeties to "off safe" and fire. Be sure you have a safe backstop.

THINK! What will you **HIT** if you **MISS** the target?

INSTANT LOADING

The **LAW 12** may be carried with the bolt open, chamber empty, and magazine loaded yet still be instantly readied for firing. To use this feature, engage the magazine cut-off button. Open the bolt. It will lock open. When you strike a fairly hard glancing blow to the magazine cut-off button a shell will be released from the magazine, lifted into position and loaded into the chamber as the bolt closes.

But use caution. Unless you first put the carry safety lever in the "on safe" position the shotgun is ready to fire when the bolt closes.

SOME TIPS ON FIRING

CHANGING THE CHAMBERED CARTRIDGE

When you wish to fire a type of shell not in the magazine, you need not cycle all remaining shells through the action to clear the chamber. Press in the magazine cut-off button. Flip the quick employment safety back to its "on safe" position. Open the bolt by pulling back on the operating handle to eject the shell in the chamber. Place the desired shell in the receiver and **close the bolt by pressing the carrier latch button on the left side of the receiver, NOT THE MAGAZINE CUT-OFF BUTTON.**

A jam will occur if you disengage the cut-off button before the bolt closes.

Firing the shot will release the magazine cut-off button.

MAGAZINE PLUG

The **LAW 12** comes with a nylon rod which limits the magazine to a capacity of 2 shells. To install it, unscrew the magazine extension and insert the narrow end toward the receiver, inside the large magazine spring. Place the magazine extension over the wide end of the rod and screw it back onto the magazine tube. **Be sure to tighten the magazine extension very firmly.**

4 AMMUNITION

Because of the dangers of poor or nonexistent quality control standards among some companies and people who make reloaded ammunition, and the well known fact that dangerous overloads and underloads (squib loads) sometimes occur, we recommend that only good quality factory ammunition be fired in the **LAW 12. If you prepare your own handloads do not exceed recommended pressures in line with those generated by factory loads as manufactured by Remington, Winchester, Sovereign, Federal or other reputable companies.**

You must use loads which provide sufficient energy to ensure reliable operation. These may be 2³/₄" standard or magnum bird shot, buckshot or slug loads. You may wish to test various combinations of shot charges and powder charges to find a load (or set of loads) which appeals to you. As with any semi-automatic shotgun, the **LAW 12** requires firm resistance to the recoil of the gun, for continuous functioning. Place the stock solidly against your shoulder.

DOUBLE FEEDING IS NOT A JAM

NO PROBLEM: SHELL IS
ON CARRIER AND BOLT
IS CLOSED

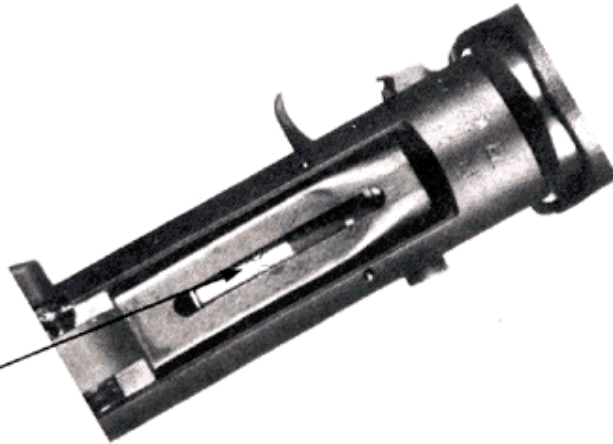

If you see that a shell has slipped out of the magazine, under the closed bolt resting on the shell carrier, THIS IS NOT A JAM. Simply fire the gun or cycle the action by hand and the **LAW 12** will feed that shell into the chamber without allowing another shell to come out of the magazine. You need not use the magazine cut-off button or do anything else. The next shell will feed normally.

5 INTERCHANGEABLE CHOKES



THREAD PROTECTOR
(CYLINDER BORE)



EXPOSED MUZZLE



OPTIONAL FULL OR
MODIFIED CHOKE

Franchi Rapid chokes fit all **LAW 12** shotguns. They are available in full and modified chokes, both of which are 4" long and add 2 1/2" of effective barrel length. To change chokes, unscrew the thread protector or choke, and screw on the desired replacement.

**POLICE AGENCY NOTE: FOR COMPATIBLE
LAUNCHER CAPABILITY CONTACT A.A.I.
CORPORATION, COCKEYSVILLE, MARYLAND**

6 HOW TO USE OPTIONAL FOLDING STOCK



To extend the stock, press the stock detent button on the upper right side of the pistol grip. Swing the stock up and back, and lower the stock to its locked position. Press the butt plate detent button and rotate the butt plate down until it locks.

To fold the stock you may straighten the butt plate before or after relatching the stock.

THE BUTT HOOK

The butt hook can be inserted in the hole in the end of the butt plate. PUSH HARD to compress the spring inside the butt plate and rotate the hook once its retaining pin is inside the butt plate.



In its forward position the butt hook is a convenient carrying handle.

With the folding stock extended it is out of the way when firing from the shoulder.

For one-hand firing either right- or left-handed rotate the hook to the right or left position.

This allows you to fire around a corner or barricade without exposing yourself to view. When doing this it is difficult to provide enough resistance to recoil, to allow functioning in semiautomatic mode.

You may have to thrust the gun forward as you pull the trigger because your bent arm acts like a shock absorber and permits the gun to recoil excessively.

7 FIELD STRIPPING AND MAINTENANCE

DISASSEMBLY



With the magazine and chamber empty, pull the bolt back to the open position and leave it open. Unscrew the magazine extension and remove the magazine spring. Pull the barrel / forend assembly forward to separate it from the receiver.



HOLDING THE OPERATING HANDLE FIRMLY, GENTLY close the bolt. Do not let it slam forward without the barrel securely in place. Permanent damage to the receiver could result.



Notice that the breech block now slides back and forth freely about 1/2". Holding the cocking slide and piston, compress the action spring a little so you can center the operating handle in its slot in the breech block. Pull the operating handle out and slowly ease the tension of the action spring.



Slide the piston, cocking slide, spring and bolt assembly forward and out of the receiver. **WATCH HOW THEY COME APART!** You will be trying to figure out how to get them back together in a few minutes.

The black "O" ring (Part No. 58) ring goes on the gas piston (Part No 57) at the forward end. If it comes off during cleaning be sure to put it back in place.

The trigger assembly can be removed by using a proper size punch to drive out the two retaining pins. Disassembly of the trigger mechanism is not recommended and not necessary for cleaning.

**TRIGGER ASSEMBLY
RETAINING PINS
(Part No 22)**



CLEANING

Use nitro solvent and a light gun oil to clean and lubricate the bore. Clean the bolt assembly and upper receiver with solvent, then apply a light coat of oil. Put a small amount of oil on the magazine tube.

A small brush will work better than a cleaning patch in some areas, such as the receiver and the trigger group.

Too much oil can eventually become gummy and cause sticking of parts and malfunctions. You must oil the steel surfaces to guard against rust, but do so sparingly.

REASSEMBLY

Put the action spring back onto the magazine tube. Slide the piston into place.

Fit the cocking slide to the piston, and the reassembled bolt to the cocking slide, and slide it into the receiver.

Flip the quick employment safety back to its "on safe" position.

Carefully pull back on the operating handle until the bolt locks open.

Fit the barrel / forend assembly over the magazine tube and into the receiver.

Replace the magazine spring and screw on the magazine extension.

WARNING!

SCREW THE MAGAZINE EXTENSION ON TIGHT! THIS IS WHAT HOLDS THE GUN TOGETHER! Check the magazine extension from time to time to be sure it is tight. If it loosens, the bolt will remain locked shut after firing and the gun will require simple disassembly to clear it and unlock the bolt. If there are shells in the magazine, the magazine spring will be under extra tension, so use caution when unscrewing the magazine extension.

DO NOT USE TOOLS TO TIGHTEN MAGAZINE EXTENSION.

CHECK FOR PROPER REASSEMBLY

Be sure the magazine extension is screwed on all the way.
Close the bolt.

If properly assembled the bolt will lock and it will not be possible to open it until you move the quick employment safety to "on".

N°	DESCRIPTION	PRICE
1	Stock group	R1
2	Magazine tube	H1
3	Magazine extension to 8 rounds	I7
4	Swivel	A5
5	Swivel retaining ring	A5
6	Receiver shock absorber	B5
7	Carrier latch button	C6
8	Carrier auxiliary latch	B5
9	Carrier latch	B5
10	Carrier latch spring	A1
11	Latch pin	A1
12	Latch pin retaining spring	A1
13	Magazine shell latch	E6
14	Magazine shell latch spring	A1
15	Magazine cut-off button	D1
16	Magazine cut-off button spring	A1
17	Magazine cut-off button pin	A5
18	Locking block shoe	B5
19	Magazine follower	A5
20	Magazine spring	A5
21	Trigger plate assembly	Q1
22	Trigger plate pin	A1
23	Cocking rod	I7
24	Breech block slide	L1
26	Operating handle	D1
27	Operating handle spring	A1
28	Breech block	N7
29	Locking block	G7
30	Firing pin	B5
31	Firing pin spring	A1
32	Elastic firing pin	A1
33	Extractor	D1
34	Extractor plunger	A1
35	Extractor spring	A1
36	Extractor pin	A1
37	Action spring	C6
41	Front sight	A1
42	Low forend	M5
43	Forend front support	E1
44	Key	E1
45	Rubber ring	A1
46	Cylinder rubber O-ring	A1
47	Bearing washer	A1
48	Retaining ring	A1
51	Barrel extension	M1
52	Ejector	B5
53	Thread protection bushing	G6
54	Choke tube rubber ring	A1
55	Cocking rod retaining spring	A5
56	Cocking rod support	L7
57	Piston assembly	H6
58	Cylinder rubber O-ring	A1
67	Carry safety follower	A5
68	Carry safety spring	A1

N°	DESCRIPTION	PRICE
75	Stock frame	H6
76	Butt plate	F6
77	Butt plate pivoting pin (folding stock version only)	A5
78	Butt plate hinge circlip	A1
79	Butt plate stop pin	A5
80	Sear spring	A5
81	Butt plate stop pin bushing	C1
82	Butt plate stop pin retainer	A1
83	Butt plate shock absorber	B5
86	Arm rest plugger	A1
87	Arm rest (folding stock version only)	E6
88	Arm rest spring	A5
89	Arm rest spring bushing	B5
90	Arm rest spring stop	B1
92	Trigger plate	H4
93	Carrier	E1
94	Breech block latch	D1
95	Breech bolt latch pin	A1
96	Breech bolt latch internal pin	A1
97	Carrier main spring	A1
98	Carrier auxiliary spring	A1
99	Breech bolt latch spring follower	A1
100	Carry safety	G2
101	Carry safety spring retaining pin	A1
102	Trigger	D1
103	Trigger pin	A1
104	Spacer	A1
105	Trigger lever	B1
106	Trigger lever pin	A1
107	Hammer	B5
108	Hammer pin	A1
109	Hammer spring	A1
110	Hammer spring follower	A1
111	Sear	D1
112	Sear pin	A1
113	Sear spring	A5
114	Quick Employment	C1
115	Rear trunnion	A5
116	Front trunnion	A5
117	Quick Employment	A1
118	Quick Employment	A1
119	Trigger guard pin bushing	A5
120	Trigger guard pin locking spring	A1
122	Stock hinge pin	B1
123	Stock hinge pin washer	A1
125	Stock ring pin	A1
126	Stock hinge through pin	B1
127	Stock hinge through pin	B1
48	Butt plate screw	A1
58	Butt plate	B3

LAW 12

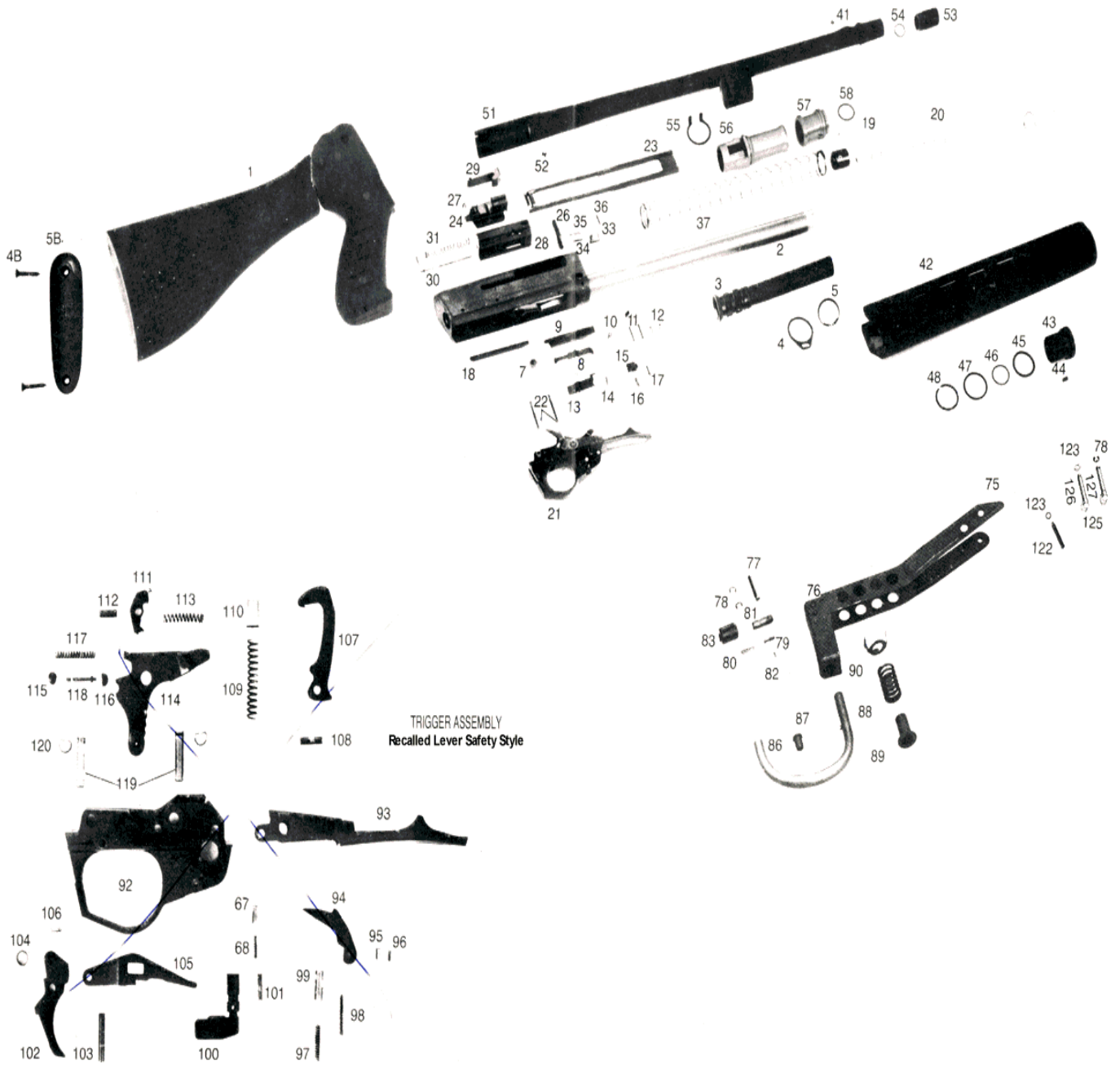

SPECIFICATIONS:

barrel length 21 1/2"
total length 41 1/2"
weight empty 7 lbs., 4 oz approx.
gauge 12
ammunition 23/4"
capacity 8 rounds in magazine + 1 in the chamber

double safety system: quick employment safety on left side of trigger guard
carry safety on right side of trigger guard.

ONE YEAR LIMITED WARRANTY

All FIE guns are warranted to the original retail customer for one year from date of purchase against defects in material and workmanship. All parts and labor or replacement (at our option) are covered.

Transportation to and from our repair facilities, damage caused by failure to perform normal maintenance, sales outside the United States, damage due to use of high velocity, high pressure, reloaded or other nonstandard ammunition, or any unauthorized repair, modification, misuse, abuse or alteration of the product is not covered by this Limited Warranty. Any implied warranties, including the implied warranties of merchantability and fitness for a particular purpose, are limited to one year from date of original retail purchase. Consequential or incidental damages or expenses, or any other expenses are not covered by this warranty.

To obtain warranty performance send your product with proof of retail purchase, freight prepaid, to: FIE Corporation, 4541 N.W. 133rd Street, Opa-Locka, Florida 33054.

HOME GUN SAFETY IS PROBABLY YOUR BIGGEST CONCERN

Hoppe's Gun Guardian is a good inexpensive gun lock kit. It works on any firearm (rifle, pistol or shotgun) or airgun, yet is instantly removable by an adult.

Hoppe's Gun Guardian kits are available in gun shops and sporting goods departments, or from Hoppe's, Airport Industrial Mall, Coatesville, PA. 19320. F.I.E. has tested them and we recommend them. After all, you have invested this much in your new gun. Now invest a little more in your children's safety.

YOUR OWNER'S MANUAL

This manual contains important warnings which must be understood BEFORE using this firearm. Always keep it with the firearm.

When you lend, give or sell the firearm, be sure the manual goes with it. You can get a copy of this manual from FIE on request.

FRANCHI 10/87
(4800980710)

FRANCHI
12 GAUGE
SEMIAUTOMATIC
SHOTGUN

LAW 12

WARNING

THIS GUN WAS MANUFACTURED TO PERFORM PROPERLY WITH THE ORIGINAL PARTS AS DESIGNED IT IS YOUR DUTY TO MAKE SURE ANY PARTS YOU BUY ARE INSTALLED CORRECTLY AND THAT NEITHER REPLACEMENTS NOR ORIGINALS ARE ALTERED OR CHANGED, YOUR GUN IS A COMPLEX TOOL WITH MANY PARTS THAT MUST RELATE CORRECTLY TO OTHER PARTS. PUTTING A GUN TOGETHER WRONG OR WITH MODIFIED PARTS CAN RESULT IN A DAMAGED GUN, DANGER, AND INJURY OR DEATH TO YOU AND OTHERS THROUGH MALFUNCTION. ALWAYS LET A QUALIFIED GUNSMITH WORK ON YOUR GUN OR AT LEAST CHECK ANY WORK NOT PERFORMED BY A GUNSMITH. WE AT FIE THINK THIS IS A SMALL PRICE TO PAY FOR FIREARMS SAFETY.

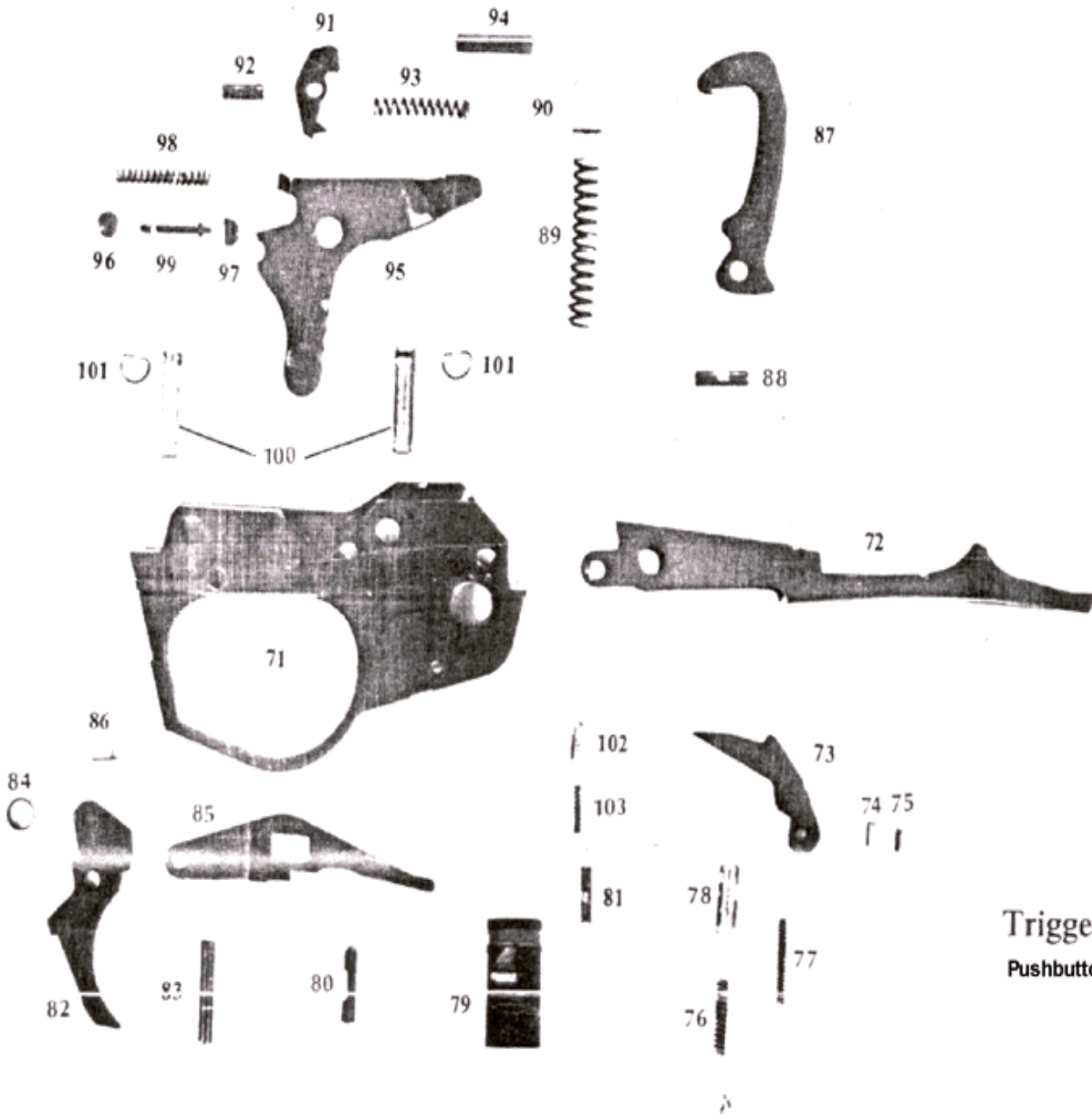

Trigger assembly
 Pushbutton Safety Style

Pushbutton Safety Style

N°	CODE	DESCRIPTION	P. CODE
71	3K41820010	Trigger plate	H4
72	3K41550010	Carrier	E1
73	3A41530820	Breech block latch	D1
74	3A41740030	Breech bolt latch pin	A1
75	3241740120	Breech bolt latch internal pin	A1
76	3A41690870	Carrier main spring	A1
77	3A41690880	Carrier auxiliary spring	A1
78	3A41500810	Breech bolt latch spring follower	A1
79	3K41420010	Hand safety	G2
80	3K41760100	Hand safety piston	A1
81	3K41740050	Hand safety spring retaining pin	A1
82	3K41600010	Trigger	D1
83	3546740060	Trigger pin	A1
84	3K41430010	Spacer	A1
85	3K41640040	Trigger lever	B1
86	3K41740080	Trigger lever pin	A1
87	3K41460010	Hammer	B5
88	3141740080	Hammer pin	A1
89	3141690130	Hammer spring	A1
90	3141500040	Hammer spring follower	A1
91	3K41530010	Sear	D1
92	3K41740090	Sear pin	A1
93	3K41690120	Sear spring	A5
94	3K41740360	Sear spring guide	A1
95	3K41640030	Auto safety lever	C1
96	3K41740100	Rear trunnion	A5
97	3K41740070	Front trunnion	A5
98	3K41690070	Auto safety spring	A1
99	3K41760050	Auto safety spring guide	A1
100	3A41430020	Trigger guard pin byshing	A5
101	3A41690070	Trigger guard pin locking spring	A1
102	3K41500030	Hand safety follower	A5
103	3K41690110	Hand safety spring	A1